

SPECIFICATIONS

martor

ARTICLEDesignation : **Secunorm 540 cutter**Code bobet : **24671**Selling Unit : **Unit**

Non-contractual pictures

**CHARACTERISTICS****ROBUST SAFETY KNIFE WITH 36MM CUTTING DEPTH AND SEMI-AUTOMATIC BLADE RETRACTION**

- Ambidextrous
- Stainless steel blade
- Aluminum handle
- The blade retracts Semi-automatically into the handle, as soon as the cut is engaged, remove your thumb from the cursor and the cutting edge immediately retracts into the handle as soon as it leaves the material to be cut
- Quick and safe blade change (thanks to the magnet)
- Fixing eyelet
- Extremely abrasion resistant
- High security
- Ergonomic
- Cutting depth: 36 mm
- Dimensions of the cutter: 143x17x31 mm
- Weight of the cutter: 79 g
- Packaging: 10 pieces

COMPATIBLE BLADES:

reference Martor 17940 to be bought specially (does not belong to our standard range of products)

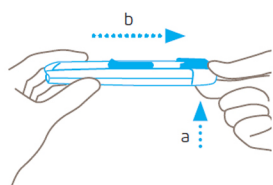

Appuyez sur le bouton de changement de lame et tirez l'insert en plastique vers l'arrière pour le sortir du manche.

Press the change button blade and pull the insert plastic towards the rear for the come out of the handle.

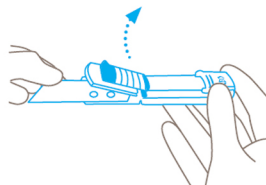

Tenez la lame du côté **non affûté** et utilisez-la pour soulever le cache-lame. Le cache reste en position ouverte.

Hold the blade on the **unsharpened** side and use it to lift the blade cover. The cache remains in open position.

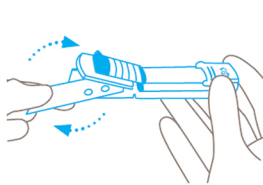

Retirez et retournez (pour gauchers) ou changez la lame. Veillez à bien réinstaller la lame en la plaçant **exactement sur l'ergot**.

Remove and return (for left-handed users) or change the blade. Take care to properly reinstall the blade in the placing **exactly on the lug**.

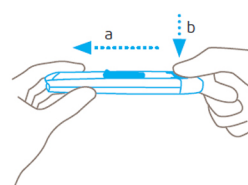

Refermez la protection de la lame et repoussez l'insert en plastique dans le manche jusqu'à ce que le bouton de changement de lame reprenne sa position initiale.

Close the blade guard and push the plastic insert back in the handle until the blade change button returns to its initial position.